

TAIH (Formerly TAI500)

Measuring Current Transformers



- Busbar window 51 x 12.5mm
- Moulded terminal cover
- Moulded DIN rail clip/mounting feet
- Secondary terminals M4 screws and 6.3 x 0.8mm fast-on
- Weight 400g
- Optional sealable terminal Cover (ATACOP02)

Dimensions

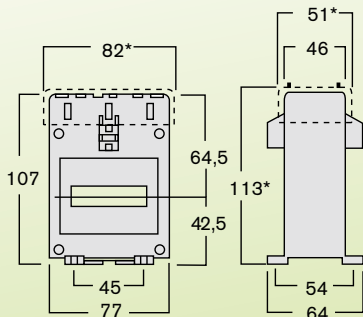

Current Transformer Ratios

| Primary Current | Burden | | | Code |
|-----------------|------------|----------|----------|------|
| | cl. 0.5 VA | cl. 1 VA | cl. 3 VA | |
| 250 | - | - | 3 | 250 |
| 300 | - | 2 | 4 | 300 |
| 400 | - | 4 | 6 | 400 |
| 500 | 2 | 4 | 6 | 500 |
| 600 | 6 | 8 | 10 | 600 |
| 700 | 8 | 10 | 12 | 700 |
| 750 | 8 | 10 | 12 | 750 |
| 800 | 8 | 10 | 12 | 800 |
| 1000 | 10 | 12 | 15 | 100 |
| 1200 | 12 | 15 | 20 | 120 |

1A or 5A Secondary

How to Order / Model Reference

eg **TAIH 50 B 100**

| | | |
|------------------------------------|------|--|
| Model | TAIH | |
| Output | | |
| -/5A Secondary | 50 | |
| -/1A Secondary | 10 | |
| Primary | | |
| 40...80A | B | |
| 250...800A | C | |
| 1000...1200A | D | |
| Range | | |
| Select code from ratio table above | ??? | |

DATA SHEET : RD1240

TA90321 (Formerly TAS50)

Measuring Current Transformers

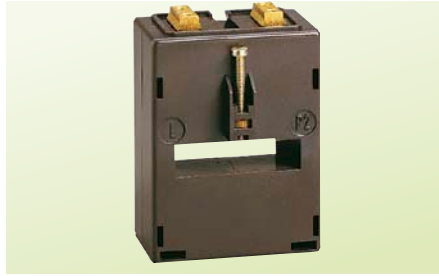

- Busbar window 51 x 12.5mm
- Secondary terminals M4 screws and 6.3 x 0.8mm fast-on
- Supplied with fixing feet and busbar mounting bracket
- Optional sealable terminal cover (ATACOP03)
- Weight 430g
- Optional double ratio

Dimensions

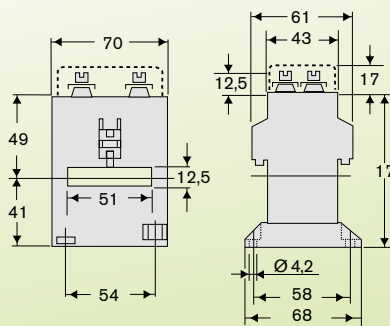

Current Transformer Ratios

| Primary Current | Burden | | | Code |
|-----------------|------------|----------|----------|------|
| | cl. 0.5 VA | cl. 1 VA | cl. 3 VA | |
| 400 | - | 4 | 6 | 400 |
| 500 | 2 | 4 | 6 | 500 |
| 600 | 6 | 8 | 10 | 600 |
| 800 | 8 | 10 | 12 | 800 |
| 1000 | 10 | 12 | 15 | 100 |
| 1200 | 12 | 15 | 20 | 120 |

5A Secondary

How to Order / Model Reference

eg **TA90321 500**

| | | |
|---------|---------|--|
| Model | TA90321 | |
| Output | | |
| 400/5A | 400 | |
| 500/5A | 500 | |
| 600/5A | 600 | |
| 800/5A | 800 | |
| 1000/5A | 100 | |
| 1200/5A | 120 | |

DATA SHEET : RD1245

TASH, TAWA (Formerly TAS63/TAS63P)

Measuring and Protection Current Transformers



- Busbar window 64 x 19mm, 51 x 20mm, 41 x 21mm or 10 x 24mm
- Secondary terminals M4 screws and 6.3 x 0.8mm fast-on
- Supplied with busbar mounting bracket
- Optional sealable terminal cover (ATACOP03)
- Weight 720g
- Optional double ratio

Dimensions

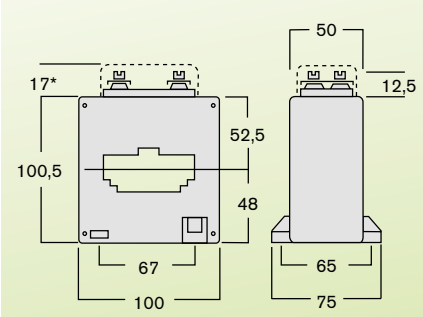

Current Transformer Ratios

| Primary Current | TASH | | | | TAWA | | | Code |
|-----------------|------------|----------|----------|--------|--------|---------|-----|------|
| | cl. 0.5 VA | cl. 1 VA | cl. 3 VA | 5P5 VA | 5P5 VA | 5P10 VA | | |
| 150 | - | 1.5 | 5 | - | - | - | 150 | |
| 200 | - | 3 | 8 | - | - | - | 200 | |
| 250 | 2 | 5 | 5 | 2 | 2.5 | 1 | 250 | |
| 300 | 3 | 6 | 6 | 3 | 3.5 | 1.2 | 300 | |
| 400 | 6 | 12 | 12 | 3 | 4 | 1.5 | 400 | |
| 500 | 6 | 12 | 12 | 4 | 5 | 6 | 500 | |
| 600 | 10 | 20 | 20 | 4 | 6 | 6 | 600 | |
| 700 | 12 | 25 | 25 | 5 | 7 | 8 | 700 | |
| 750 | 12 | 25 | 25 | 5 | 7 | 10 | 750 | |
| 800 | 12 | 25 | 25 | 5 | 7 | 10 | 800 | |
| 1000 | 15 | 30 | 30 | 6 | 7 | 10 | 100 | |
| 1200 | 20 | 40 | 40 | 6 | 10 | 12 | 120 | |
| 1250 | 20 | 40 | 40 | 8 | 10 | 15 | 125 | |
| 1500 | 20 | 40 | 40 | 8 | 10 | 15 | 150 | |
| 1600 | 20 | 40 | 40 | 8 | 10 | 15 | 160 | |

1A or 5A Secondary

How to Order / Model Reference

eg **TASH 50 C 400**

| | | |
|------------------------------------|------|--|
| Model | TASH | |
| Output | | |
| 0.5, 1, 3, 5P5 | TASH | |
| 5P5, 5P10 | TAWA | |
| Output | | |
| -/5A Secondary | 50 | |
| -/1A Secondary | 10 | |
| Primary | | |
| 150...800A | C | |
| 1000...1600A | D | |
| Range | | |
| Select code from ratio table above | ??? | |

DATA SHEET : RD1250